



FORD F-150

2009 V8-4.6/5.4L

P/N
49-43015

PERFORMANCE EXHAUST

Features:

- High performance
- 3.5" mandrel-bent tailpipe
- 3" mid-pipe
- 409 SS construction
- OE-style clamps and hangers
- Performance sound on demand

Benefits:

- + 55% flow increase
- Increased MPG

Tip included

aFepower.com



Tech Sheet

Exhaust Systems



P/N 49-43015



Material
Clamps
Tailpipe
Tip
Install Time

3.5" 409 stainless tube (3" mid-pipe)
Band clamp
1-piece
Welded (304 SS) 3.5" x 4.5" x 12"
1 hour

Application

Make Ford

Model F-150

Year 2009

Engine V8-4.6/5.4L Triton

Chassis 4x2, 4x4,
132.5" WB, 138.5" WB,
144.5" WB, 150.5" WB

Features & Benefits

Bayonet hangers

Swaged bayonet ends lock your exhaust component into place for the most secure installation possible. Other manufacturers use less expensive bent hangers that allow tubes and parts to slide from side to side, causing premature wear and damage.

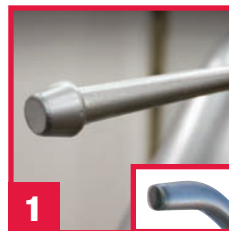

Welded-on hangers

Every hanger is thoroughly welded on each side to ensure a stronger connection, compared to other manufacturers who use only inferior floating hangers.

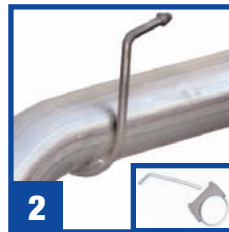

Band style clamps

Premium-quality band clamps are used on critical joints to provide the tightest, leak-free seal possible. Other systems use common, less expensive U-bolt clamps.



Mandrel bent

All aFe tubing is 100% mandrel-bent. Mandrel bending ensures the tubing maintains its shape and size, providing smooth, unrestricted airflow. Standard tubing can lose as much as 20% of its diameter in sharp bends.



LARGE 3.5" DIA OVER AXLE/TAIPIPE WITH 4.5" POLISHED S/S TIP

Also available OE Filter P/N 30-10162 Filter not included



P/N 49-43015
Cat-back

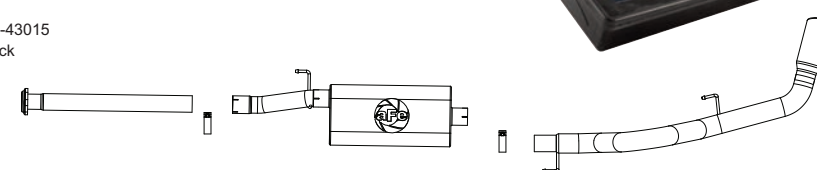

Performance Data

Torque See aFepower.com

HP See aFepower.com

CFM Up to 55% cfm increase



See chart at left

	Description	P/N	Box Size	UPC	Weight	MSRP	Jobber
	Exhaust	49-43015	59" x 14" x 19"	80295949464	48 lbs.	\$587.06	\$499.00
	Air Filter	30-10162	14" x 11" x 3"	80295930166	2 lbs.	\$68.76	\$58.45
	Air Filter	31-10162	14" x 11" x 3"	80295931117	2 lbs.	\$67.59	\$57.45

advanced FLOW engineering

252 Granite St. Corona, CA 92879 • 951.493.7100 • FAX: 951.493.7177 • aFepower.com

49-12363

Last update: 9-2008